

SECTOR-86

SERVICE ROAD 12.0M WIDE

SECTOR ROAD 60.0M WIDE

SERVICE ROAD 12.0M WIDE

SECTOR-81

9 KARAM REVENUE RASTA

- LEGEND:-**
- SEWER MANHOLE (800x900)mm
 - EXTERNAL SEWER MANHOLE 910#
 - 200# EXTERNAL SEWER PIPE
 - CATCH BASIN (CB 600x600)mm
 - 150# STORM WATER LINE
 - EXTERNAL STORM MANHOLE 910#
 - 300# EXTERNAL STORM WATER LINE
 - 400# EXTERNAL STORM WATER LINE
 - DOMESTIC WATER SUPPLY RING
 - FLUSHING WATER SUPPLY RING
 - TUBE WELL LINE
 - CITY WATER SUPPLY LINE
 - IRRIGATION LINE
 - EXTERNAL FIRE HYDRANT LINE
 - 250MM WIDE SAUCER DRAIN
 - GARDEN HYDRANT
 - EXTERNAL FIRE HYDRANT
 - WATER METER
- NOTE:-**
- RHP: RAIN WATER HARVESTING PIT SIZE = 4.0X3.0X2.5m Deep
 - DC: DISINTEGRATING CHAMBER SIZE = 2.0X1.5X1.5m Deep

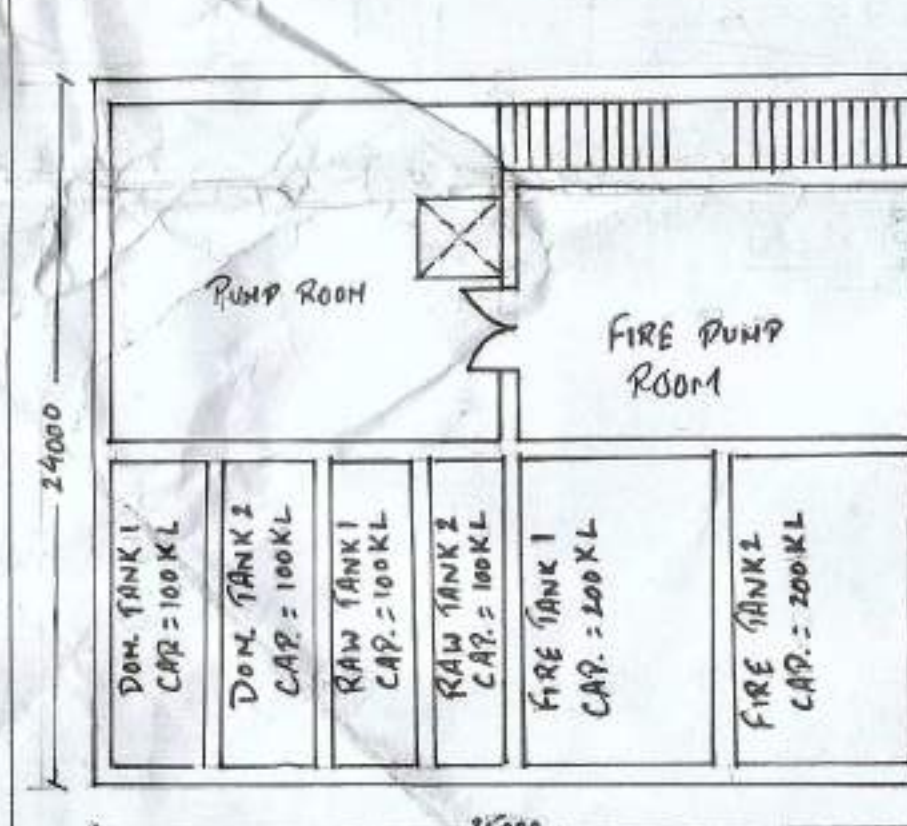

NOTE: NOT TO SCALE

These plans have been checked and found in order as per Public Health Services point of view

This is a "PROVISIONAL BUILDING PLAN" approved only for the purpose of filing objections from the general public.

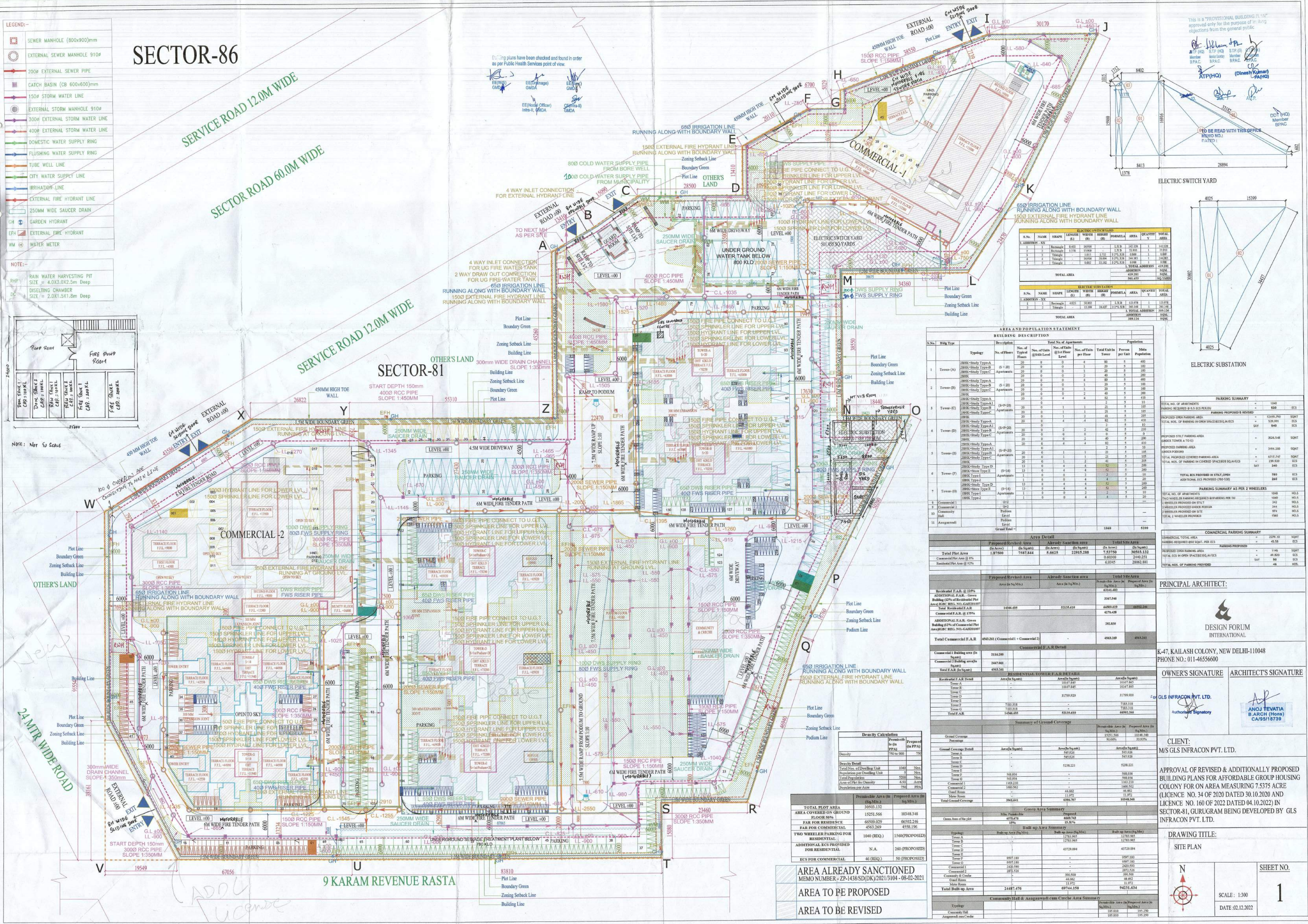

AREA AND POPULATION STATEMENT

S.No.	Name	Shape	Length (m)	Width (m)	Perimeter (m)	Area (sq.m)	Quantity	Total Area
1	Rectangular	4400	16500	16500	122100	122100	1	122100
2	Rectangular	1700	12000	12000	42000	42000	1	42000
3	Triangle	1800	1200	1200	1800	1800	1	1800
4	Triangle	1800	1200	1200	1800	1800	1	1800
5	Triangle	1800	1200	1200	1800	1800	1	1800
TOTAL AREA								170000

AREA AND POPULATION STATEMENT

S.No.	Block Type	Description	Total No. of Apartments	Total Units	Population
1	Town-A	2BHK-Study Type-A	20	20	80
2	Town-B	2BHK-Study Type-B	20	20	80
3	Town-C	2BHK-Study Type-C	20	20	80
4	Town-D	2BHK-Study Type-D	20	20	80
5	Town-E	2BHK-Study Type-E	20	20	80
6	Town-F	2BHK-Study Type-F	20	20	80
7	Town-G	2BHK-Study Type-G	20	20	80
8	Town-H	2BHK-Study Type-H	20	20	80
9	Town-I	2BHK-Study Type-I	20	20	80
10	Town-J	2BHK-Study Type-J	20	20	80
11	Town-K	2BHK-Study Type-K	20	20	80
12	Town-L	2BHK-Study Type-L	20	20	80
13	Town-M	2BHK-Study Type-M	20	20	80
14	Town-N	2BHK-Study Type-N	20	20	80
15	Town-O	2BHK-Study Type-O	20	20	80
16	Town-P	2BHK-Study Type-P	20	20	80
17	Town-Q	2BHK-Study Type-Q	20	20	80
18	Town-R	2BHK-Study Type-R	20	20	80
19	Town-S	2BHK-Study Type-S	20	20	80
20	Town-T	2BHK-Study Type-T	20	20	80
21	Town-U	2BHK-Study Type-U	20	20	80
22	Town-V	2BHK-Study Type-V	20	20	80
23	Town-W	2BHK-Study Type-W	20	20	80
24	Town-X	2BHK-Study Type-X	20	20	80
25	Town-Y	2BHK-Study Type-Y	20	20	80
26	Town-Z	2BHK-Study Type-Z	20	20	80
Total				500	2000

Area Detail

Proposed Revised Area (sq. Mts.)	Already Sanctioned Area (sq. Mts.)	Total Area (sq. Mts.)
187500	7887844	8075344
Commercial Plot Area @ 1%	6.6625	6.6625
Residential Plot Area @ 2%	1552.5	1552.5
Total	8219.1125	8219.1125

Commercial F.A.R. Detail

Residential F.A.R. @ 22%	Commercial F.A.R. @ 17%	Total F.A.R.
4116.0	1387.0	5503.0
Commercial F.A.R. @ 17%	1387.0	1387.0
Total Commercial F.A.R.	2774.0	2774.0

Residential Lower F.A.R. Details

Tower	Area (sq. Mts.)	Area (sq. Mts.)	Area (sq. Mts.)
Tower A	1017.841	1017.841	1017.841
Tower B	1017.841	1017.841	1017.841
Tower C	1017.841	1017.841	1017.841
Tower D	1017.841	1017.841	1017.841
Tower E	1017.841	1017.841	1017.841
Tower F	1017.841	1017.841	1017.841
Tower G	1017.841	1017.841	1017.841
Tower H	1017.841	1017.841	1017.841
Tower I	1017.841	1017.841	1017.841
Tower J	1017.841	1017.841	1017.841
Tower K	1017.841	1017.841	1017.841
Tower L	1017.841	1017.841	1017.841
Tower M	1017.841	1017.841	1017.841
Tower N	1017.841	1017.841	1017.841
Tower O	1017.841	1017.841	1017.841
Tower P	1017.841	1017.841	1017.841
Tower Q	1017.841	1017.841	1017.841
Tower R	1017.841	1017.841	1017.841
Tower S	1017.841	1017.841	1017.841
Tower T	1017.841	1017.841	1017.841
Tower U	1017.841	1017.841	1017.841
Tower V	1017.841	1017.841	1017.841
Tower W	1017.841	1017.841	1017.841
Tower X	1017.841	1017.841	1017.841
Tower Y	1017.841	1017.841	1017.841
Tower Z	1017.841	1017.841	1017.841
Total	20356.821	20356.821	

Green Area Summary

Green Area of the Plot	Min. Provision (10%)	Proposed (18.31%)
Green Area of the Plot	18750	34185
Total Green Area	18750	34185

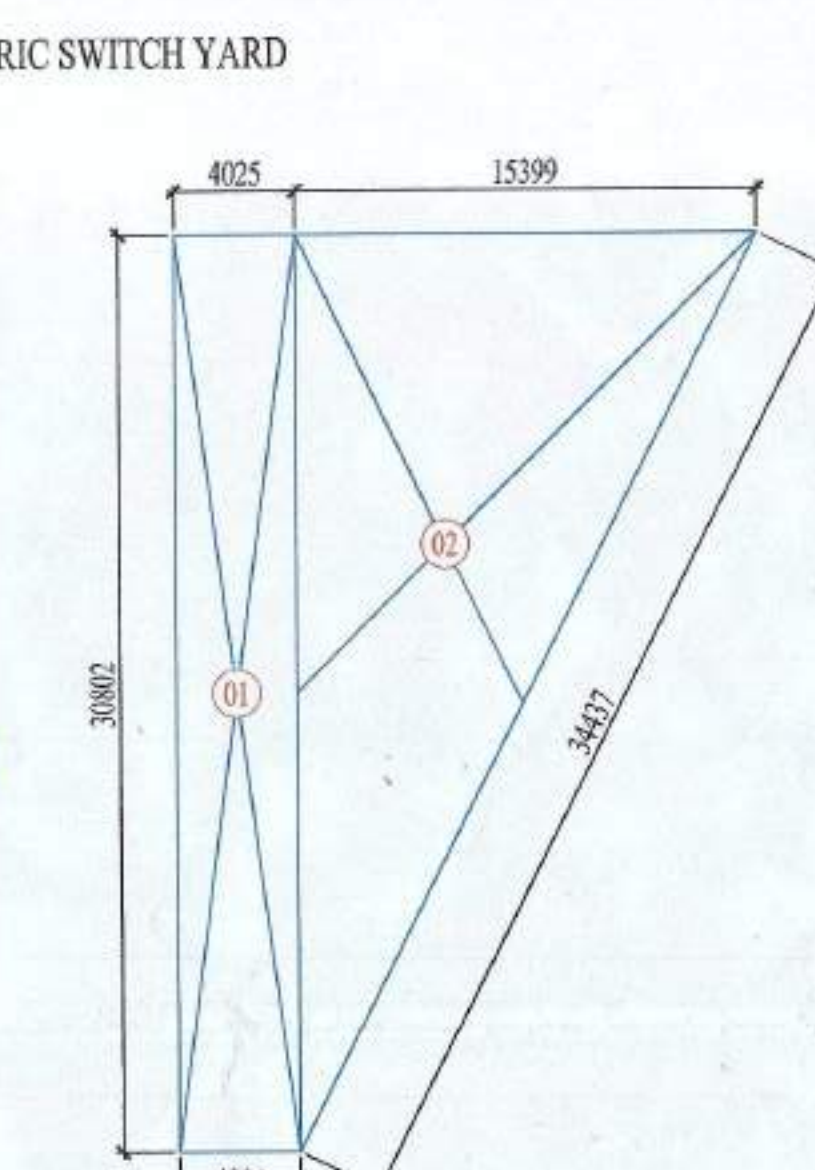

PARKING SUMMARY

Category	Quantity	Remarks
TOTAL NO. OF APARTMENTS	500	
PARKING REQUIRED @ 0.5 ECS PER UNIT	250	
PARKING PROVIDED @ 0.5 ECS PER UNIT	250	
TOTAL NO. OF PARKING PROVIDED	250	

PRINCIPAL ARCHITECT:
DESIGN FORUM INTERNATIONAL

OWNER'S SIGNATURE:
M/S GLS INFRACON PVT. LTD.

ARCHITECT'S SIGNATURE:
ANUJ TEVATIA ARCH (HONS) CA/95/18739

CLIENT:
M/S GLS INFRACON PVT. LTD.

APPROVAL OF REVISED & ADDITIONALLY PROPOSED BUILDING PLANS FOR AFFORDABLE GROUP HOUSING COLONY FOR AN AREA MEASURING 7.5375 ACRE (LICENCE NO. 34 OF 2020 DATED 30.10.2020 AND LICENCE NO. 160 OF 2022 DATED 04.10.2022) IN SECTOR-81, GURUGRAM BEING DEVELOPED BY GLS INFRACON PVT. LTD.

DRAWING TITLE:
SITE PLAN

SHEET NO.:
1

SCALE:
1:300

DATE:
02.12.2022

Density Calculation

Category	Permitted (in PPA)	Proposed (in PPA)
Density Detail	750 to 900	750
Total No. of Dwelling Unit	1040	1040
Population per Dwelling Unit	2.0	2.0
Total Population	2080	2080
Area of Plot for Density	6.30	6.30
Dwelling per Acre	165	165

AREA ALREADY SANCTIONED
MEMO NUMBER - ZP-1438(SD)/2021/3104 - 08-02-2021

AREA TO BE PROPOSED

AREA TO BE REVISED